

### SPA-1100

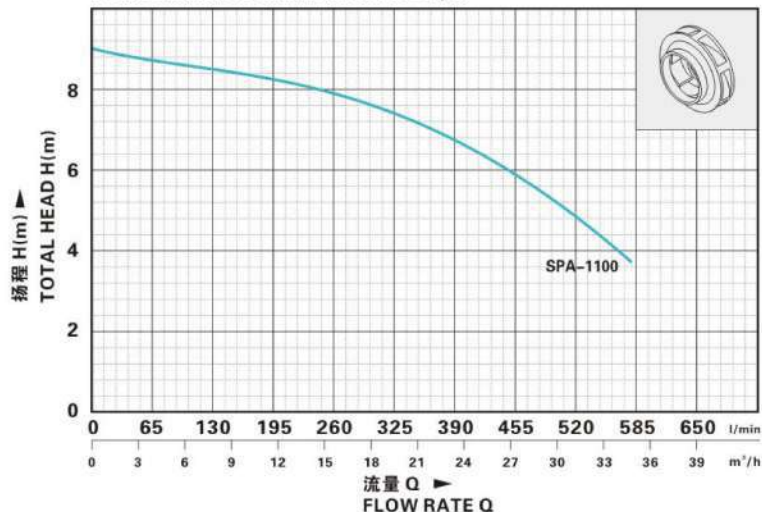

额定转速 n=2860 r/min  
PERFORMANCE CHART AT n=2860 rpm



#### 技术参数 TECHNICAL DATA:

型号 Model	SPA-1100 ( F )
功率 Power (kw)	1.1
出水口径 Outlet diameter (mm)	80
电压/频率 Voltage (V/Hz)	220/50
最大流量 Max.flow (l/min)	580 ( 34.8m³/h )
最高扬程 Max.head (m)	9
毛重 G.W. (Kg)	20.5
包装尺寸 Dimensions (cm)	45.0X31.5X24.5

#### 分解图 DIAGRAM:

#### SPA-1100F

N0.	DESCRIPTION	名称	N0.	DESCRIPTION	名称
1.	Protector	护套	28.	Mechanical seal	机械密封件
2.	Cable presser	电缆压板	29.	"O" ring	"O" 形密封圈
3.	Screw	十字盘头螺钉	30.	Out-let connector	出水接头
4.	Cable	带插头电源线	31.	"O" ring	"O" 形密封圈
5.	Flange	轧兰	32.	Pump body	泵体
6.	Cable protector	电缆护套	33.	Screw	内六角圆柱头螺钉
7.	Bolt	六角头螺栓	34.	Oil seal	骨架油封
8.	Handle	提手	35.	Impeller	叶轮
9.	Bolt	六角头螺栓	36.	Nut	六角螺母
10.	"O" ring	"O" 形密封圈	37.	Pump cover	泵盖
11.	Screw	内六角圆柱头螺钉	38.	Nut	六角螺母
12.	Washer	垫圈	39.	Bilateral bolt	双头螺栓
13.	Capacitor cover	电容罩	40.	Screw	十字盘头自攻螺钉
14.	"O" ring	"O" 形密封圈	41.	Float switch	浮球开关
15.	Capacitor	电容器	42.	Tees	三通
16.	Line protector	护线珠	43.	Rubber washer	橡胶垫片
17.	"O" ring	"O" 形密封圈	44.	Key	平键
18.	Screw	十字盘头螺钉	45.	Washer	垫圈
19.	Stretching washer	弹簧垫圈	46.	Filter mesh	底网
20.	Washer	垫圈	47.	Ball bearing	轴承
21.	Screw	十字盘头螺钉	48.	Screw	内六角圆柱头螺钉
22.	Motor cover	端盖	49.	Washer	垫圈
23.	Undulated washer	波形垫片	50.	Connection nut	接口
24.	Ball bearing	轴承	51.	Screw	十字盘头螺钉
25.	Rotor	转子	52.	Washer	垫圈
26.	Thermal protector	热保护器	53.	Nut	六角螺母
27.	Motor stator	机座	54.	Washer	垫圈

### Submersible Pump



**D100S**

Model		D100S
Bore		25 (15) mm
Maximum capacity	50Hz	70 l/min
	60Hz	69 l/min
Maximum total(net) head	50Hz	7.3m
	60Hz	8.0m
Rated output		100W
Rated voltage		100V
Rated current		2.3A
Motor overhead protection		Micro-thermal protector (MTP)
Pump weight		2.7kg

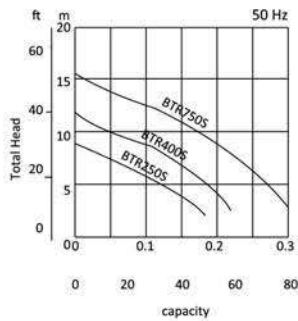

**BTR-S Series 50 Hz**

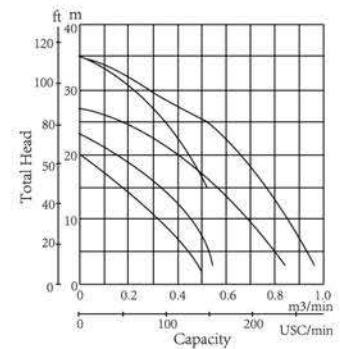

**BTR Series 50 Hz**

BTR-S Series											
Bore		Pump Model	Phase	Output kW	Capacity - Total Head				Pole	Weight	
mm	in				m <sup>3</sup> /min-m		USG/min-ft			kg	lbs
					50Hz	60Hz	50Hz	60Hz			
50	2	BTR400S	Single	0.25	0.1-6.0		26.4-19.7		2	9.0	19.8
80	3	BTR600S		0.40	0.12-8.0	0.12-10.0	31.7-26.2				
		BTR750S		0.75	0.1-12.5	0.1-13.0	26.4-41.0	26.4-42.7			
BTR Series											
50(80)	2(3)	BTR15	Three	1.5	0.3-11.0	0.3-11.8	79.3-36.1	79.3-38.7	2	19.0	41.9
80(50)	3(2)	BTR22		2.2	0.3-16.0	0.3-16.5	79.3-52.5	79.3-54.1		22.0	48.5
		BTR37H		3.7	0.2-30.5	0.2-30.8	52.8-100	52.8-101		34.0	75.0
100(80)	4(3)	BTR37L			5.5	0.4-20.0	0.4-21.0	105.7-65.6			
		BTR55		0.7-18.5		0.7-18.5	184.9-60.7	184.9-60.7			
		BTR55L		-	1.2-15.0	-	317.0-49.2	43.0		94.8	

### Submersible Pump

VT-400/400A



VT-800/800A



- Motor with built in over load thermal protector
- Body in Aluminium (VT-800 Body in Cast Iron)
- Mechanical seal in carbon ceramic with oil chamber
- A-Type with floating level switch

Model	Electric Current		Outlet Discharge	Watt	Head	Flow (l / min)
	1 Phase	3 Phase				
VT-400	220V 50 Hz / 110V 60Hz	380V 50 Hz	2"	400	13	320
VT-400 A	220V 50 Hz	380V 50 Hz	2"	400	13	320
VT-800	220V 50 Hz / 110V 60Hz	380V 50Hz	3"	750	16	380
VT-800 A	220V 50 Hz	380V 50Hz	3"	750	16	380

\* SEWAGE & AUTO FLOAT & 110V/60Hz MODELS ARE ALSO AVAILABLE



TO400

## TOYO

Size : 2"  
 Qmax : 190 l/min  
 Hmax : 9 min  
 V : 220  
 Hz : 50  
 Kw : 0.4  
 HP : 0.53



TD 110

## YAMADA

Outlet Dia. : 25mm  
 Motor : 100 watt  
 Head (Max) : 7 meter  
 Flow (Max) : 85 l/min  
 Pump casing : ABS  
 Motor shaft : Stainless  
 Impeller : ABS  
 Pump strainer : ABS  
 Float switch : x

### Submersible Dewatering Pump

- ◎ The body of motor and pump is made of rigid cast iron for long-lasting durability. Greatly increased maximum submersion depth due to mechanical seal resistant to high pressure(0.5Mpa).
- ◎ Semi-open impeller made of high chrome alloy match with wear plate(ductile iron)achievse superior durability.
- ◎ effective motor cooling due to discharge channel cast as part of the motor housing.
- ◎ Discharge 50mm(2")to 150mm(6"),motor 1.5Kw(2HP)to 11Kw(15HP). hermetically sealed motor equipped build-in thermal protection.



**Specification**

Capacity	up to 147 m <sup>3</sup> /h
Head	up to 51 meters
Power	1.5Kw(2HP)to 11 Kw(15HP)
Power Supply	three phase 380 V±10%,50Hz
Insulation Class	F
Protection Class	Ip68 Cable Length 8m
Water Temperature	up to 40 °C
Max Water Depth	50m



**Application**

- Civil Engineering
- Mines,Quarries,Coal Ore & Slurries
- Sewage treatment plants
- General pumping purposes

**\*Special Features On Request**

### Performance curves

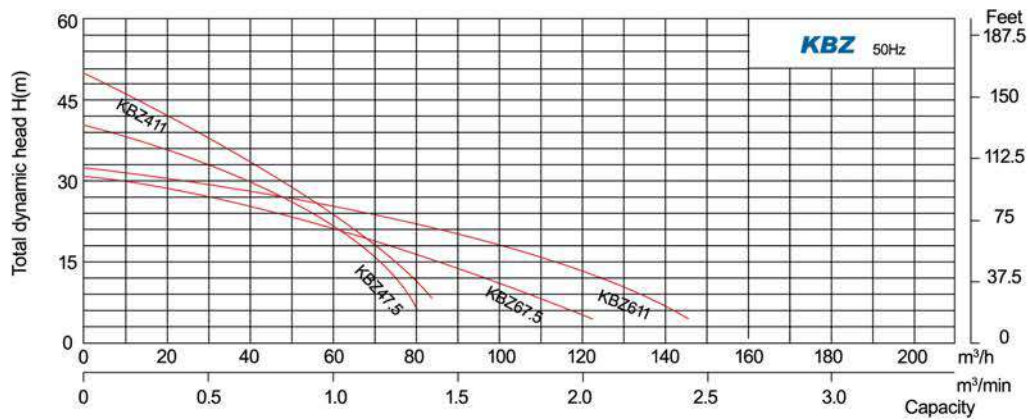
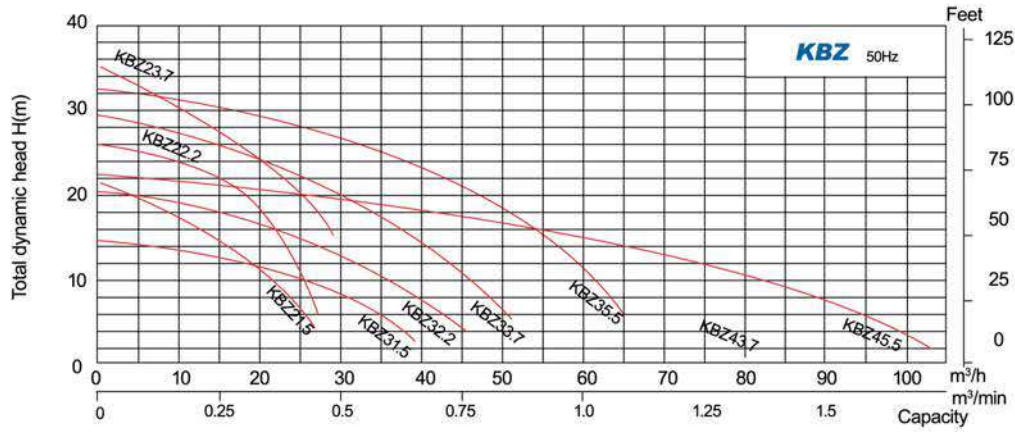

Model(50Hz)	Outlet mm	Motor power		Max head m	Max capacity		Impller passage mm	N.W kg	G.W kg	Packing dimension mm
		Kw	HP		m <sup>3</sup> /h	m <sup>3</sup> /min				
KBZ21.5	50	1.5	2	22	27.0	0.45	8.5	34.5	37.5	590x290x250
KBZ22.2	50	2.2	3	26.0	27.0	0.45	8.5	36	39	590x290x250
KBZ23.7	50	3.7	5	34.0	29.0	0.48	8.5	60	65	684x334x397
KBZ31.5	80	1.5	2	14.5	40.0	0.67	8.5	34.5	37	590x290x250
KBZ32.2	80	2.2	3	21.0	50.0	0.83	8.5	36	39	590x290x250
KBZ33.7	80	3.7	5	29.0	55.0	0.92	8.5	60	65	684x344x397
KBZ35.5	80	5.5	7.5	32.0	70.0	1.17	8.5	77	84	731x366x405
KBZ43.7	100	3.7	5	18.0	90.0	1.50	8.5	61	66	702x344x397
KBZ45.5	100	5.5	7.5	23.0	105.0	1.75	8.5	78	85	746x366x405
KBZ47.5	100	7.5	10	40.0	84.0	1.40	11.5	105	114	824x390x459
KBZ411	100	11	15	48.5	86.4	1.44	11.5	130	140	867x430x495
KBZ67.5	150	7.5	10	31.0	124.8	2.08	19.5	106	114	850x390x459
KBZ611	150	11	15	32.0	147.0	2.45	19.5	133	143	867x430x495

Submersible slurry pump with a 4-pole motor for an increased lifetime and greater convenience.

KBS-based extra powered submersible slurry pump with agitator.

Slim design with a top discharge enabling installation in smaller casing.

For bentonite mixed water in foundation works or muddy water in civil engineering works.



## Specification

- Capacity: up to 6 m<sup>3</sup>/min
- Head: up to 32 m
- Discharge 80mm (3") to 200mm (8")
- Power: 4kW (5.5HP) to 22kW (30 HP)
- Power supply: three phase 380V ± 10%, 50Hz  
380V ± 10%, 60Hz
- Insulation class: F
- Protection class: IP68
- Cable length: 8m
- Water temperature: up to 40°C
- Max. water depth: 15m

## Application

- Civil engineering
- Mines, quarries, coal ore & slurries
- Sewage treatment plants
- General pumping purposes
- Pumping fluid: sludge, liquids containing mud and bentonite

## Special features on request

- Other voltages
- The length of cable is optional

## Performance curves

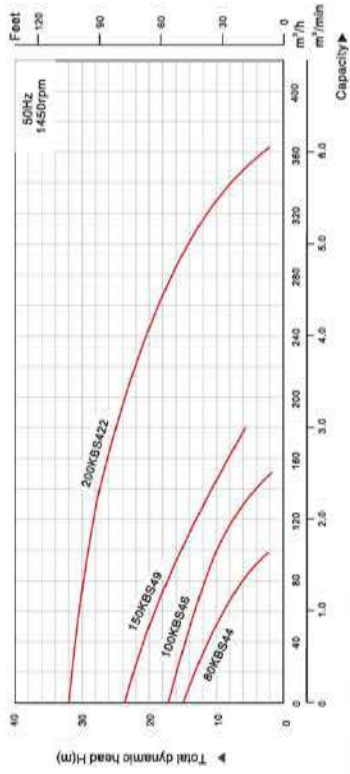

## Performance curves

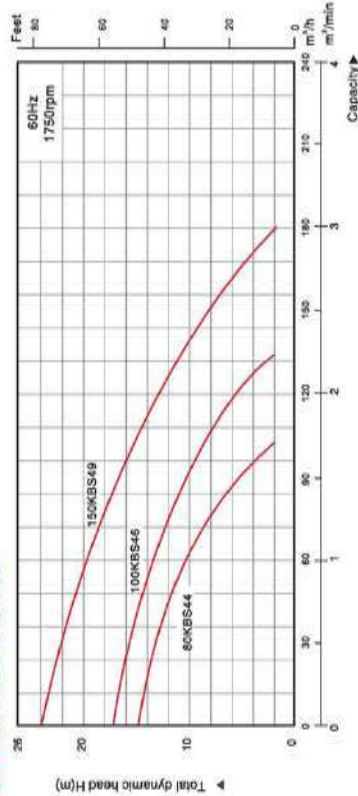

Model	Outlet		Motor power		Max head		Max capacity		Impeller passage	N.W	G.W	Packing dimension
	mm	HP	KW	HP	50Hz	60Hz	50Hz	60Hz				
80KBS44	80	4	5.5	4.8	14.8	14.5	1.65	1.70	30	105	113	855x415x400
100KBS46	100	6	8	16.9	16.5	2.50	2.35	30	145	156	415x475x390	
150KBS49	150	9	12	21.5	23.5	2.85	2.90	30	170	184	475x475x1060	
200KBS422	200	22	30	32	/	/	6	/	30	400	420	660x670x1450

Submersible slurry pump with a 4-pole motor for an increased lifetime and greater convenience.

KBS-based extra powered submersible slurry pump with agitator.

Slim design with a top discharge enabling installation in smaller casing.

For bentonite mixed water in foundation works or muddy water in civil engineering works.



### Specification

- Capacity: up to 6 m<sup>3</sup>/min
- Head: up to 32 m
- Discharge 80mm (3") to 200mm (8")
- Power: 4kW (5.5HP) to 22kW (30 HP)
- Power supply: three phase 380V ± 10%, 50Hz  
380V ± 10%, 60Hz
- Insulation class: F
- Protection class: IP68
- Cable length: 8m
- Water temperature: up to 40°C
- Max. water depth: 15m

### Application

- Civil engineering
- Mines, quarries, coal ore & slurries
- Sewage treatment plants
- General pumping purposes
- Pumping fluid: sludge, liquids containing mud and bentonite

### Special features on request

- Other voltages
- The length of cable is optional

### Performance curves

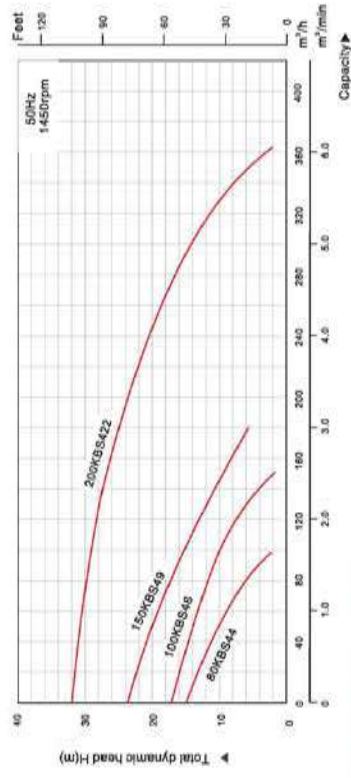

### Performance curves

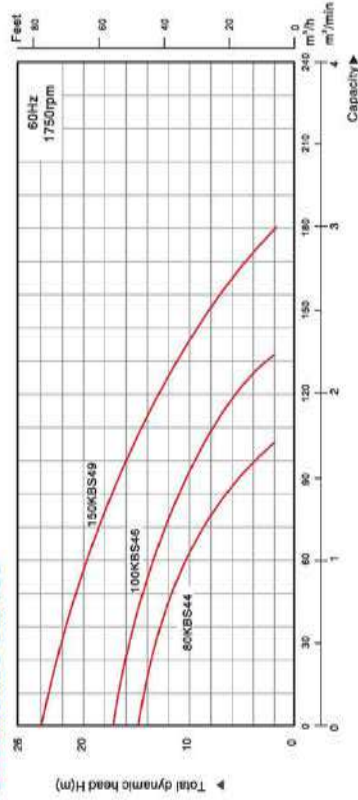

Model	Motor power		Max head (m)			Max capacity (m <sup>3</sup> /min)			Impeller passage (mm)	N.W. (Kg)	G.W. (Kg)	Packing dimension (mm)
	kW	HP	50Hz	60Hz	80Hz	50Hz	60Hz	80Hz				
80KBS44	4	5.5	14.8	14.5	16.5	1.70	2.50	2.35	30	105	113	855x415x400
100KBS46	6	8	16.9	16.5	23.5	2.90	4.20	3.90	30	145	156	415x475x690
150KBS49	9	12	21.5	23.5	2.85	2.90	170	184	30	170	184	475x475x1060
200KBS422	22	30	32	/	6	/	400	420	30	400	420	660x670x1450

30~45kW 4P

50Hz : 1450rpm

60Hz : 1750rpm

## Specification

- Insulation class : F
- Protection class : IP68
- Starting method : ≥45kW reduced-voltage starting
- Water temperature : up to 40°C
- PH : 6 to 10
- Density of liquid : 1.3g/cm<sup>3</sup>
- Power supply : three phase 380V ±10%, 50Hz  
three phase 380V ±10%, 60Hz
- Capacity : up to 1200m<sup>3</sup>/h
- Head : up to 56m
- Maximum immersion depth : 20m
- Cable Length : 8m



## Movable Soft Pipe Installation (R)

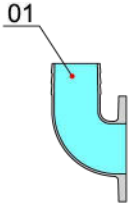

## Hard Pipe Installation(Y)

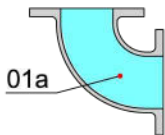

## Auto-coupled Installation (Z)

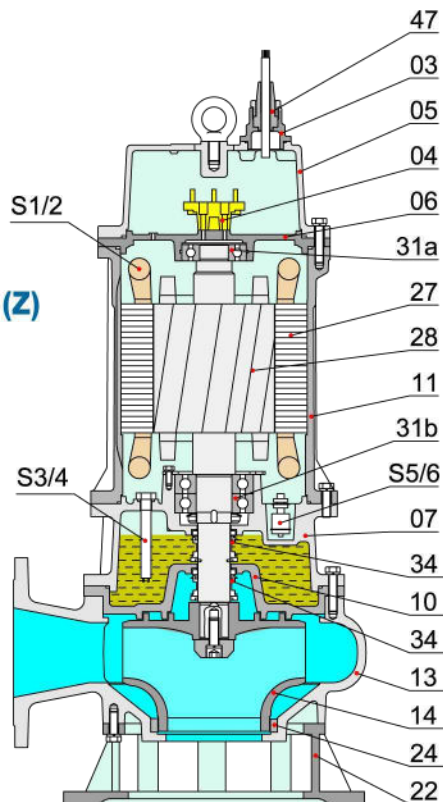
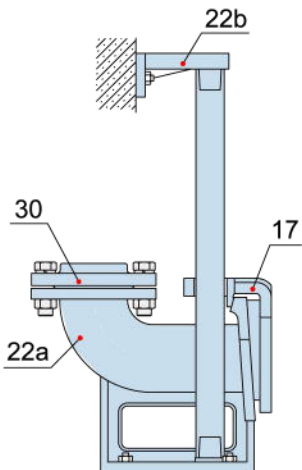

## Materials of construction

Item No.	Part name	Material
01	Hose coupling	Cast iron
01a	Hose coupling	Cast iron
03	Terminal box	Cast iron
04	Wiring terminal	
05	Upper cover	Cast iron
06	Up-Bearing house	Cast iron
07	Bearing house	Cast iron
10	Seal bracket	Cast iron
11	Motor body	Cast iron
13	Pump body	Cast iron
14	Impeller	Ductile iron
17	Coupling adapter	Cast iron
22	Seat assembly	Cast iron
22a	Coupling seat	Cast iron
22b	Upper guide support	Cast iron
24	Neck ring	High chrome alloy
27	Stator	
28	Rotor	Shaft : AISI420SS
30	Flange	Cast iron
31a	Bearing	Ball bearing
31b	Bearing	Ball bearing
34	Mechanical seal	Sic-Sic
47	Cable	
S1/2	Overheat protector	on option
S3/4	Oil water leakage probe	on option
S5/6	Floating switch	on option



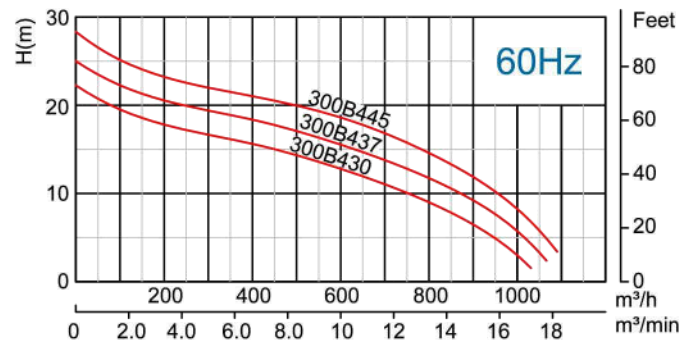
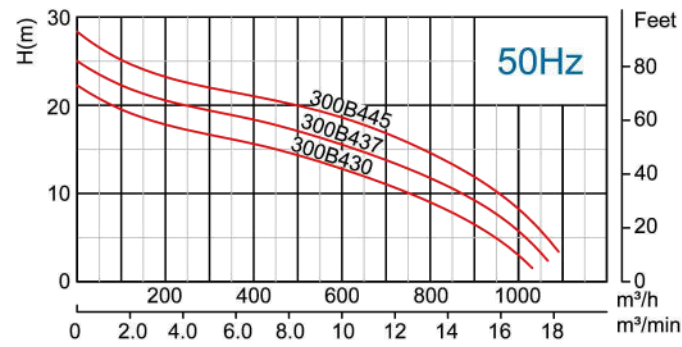
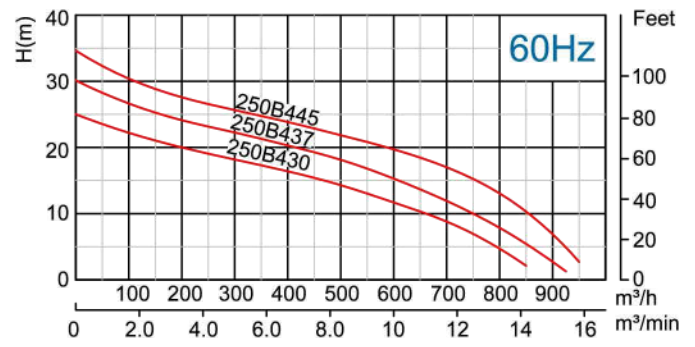
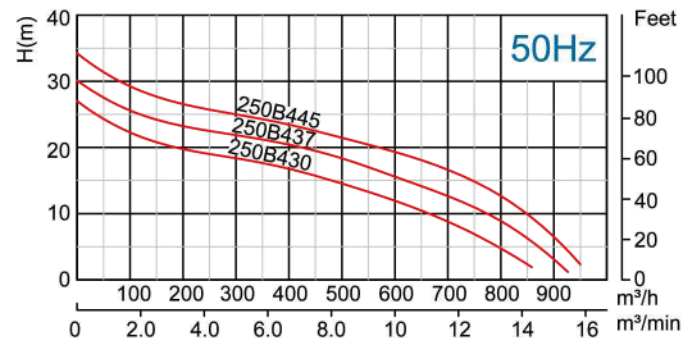
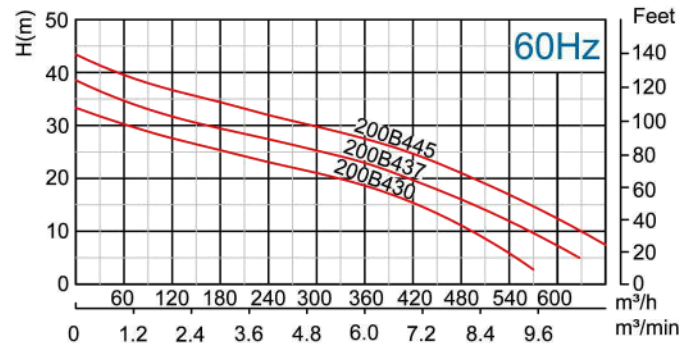
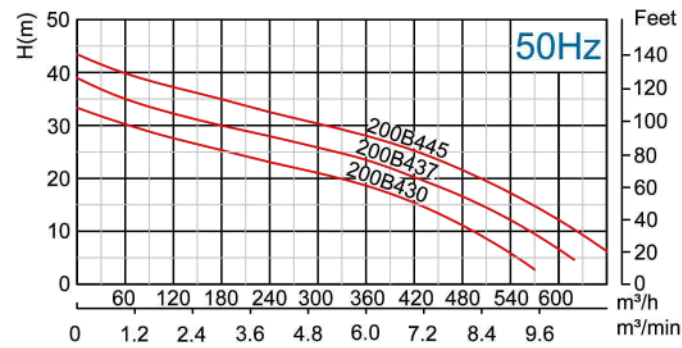
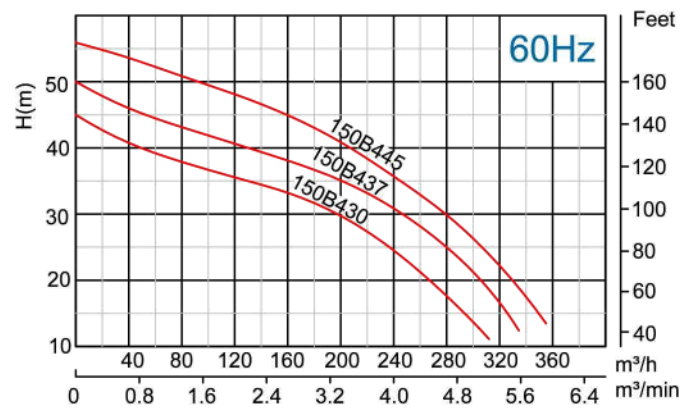
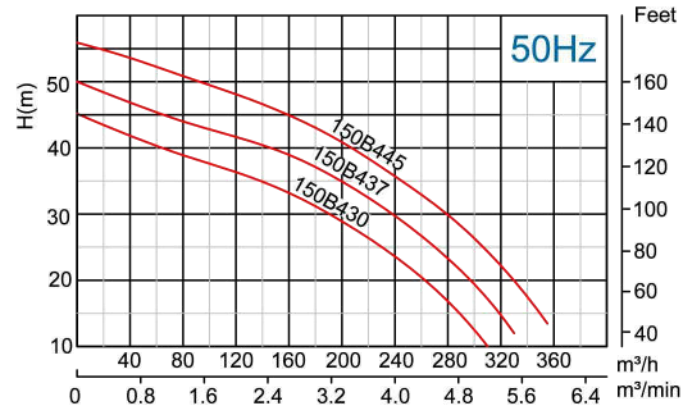

Model 50Hz/60Hz	Voltage	Current	Motor power		Outlet		Rated capacity	Rated head	Max capacity	Max Head	Impeller Passage
	V	A	kW	HP	in	mm	m³/h	m	m³/h	m	mm
150B430	380	57.6	30	40	6	150	150	34	310	45	55
200B430	380	57.6	30	40	8	200	300	21	570	33	80
250B430	380	57.6	30	40	10	250	500	14	860	27/25	90
300B430	380	57.6	30	40	12	300	800	8	1040	22	90
150B437	380	69.8	37	50	6	150	150	40	330	50	55
200B437	380	69.8	37	50	8	200	300	25	620	39	90
250B437	380	69.8	37	50	10	250	500	18	930	30	90
300B437	380	69.8	37	50	12	300	800	11	1060	25	90
150B445	380	84.5	45	60	6	150	150	45	350	56	55
200B445	380	84.5	45	60	8	200	300	30	660	43	90
250B445	380	84.5	45	60	10	250	500	21	950	34	90
300B445	380	84.5	45	60	12	300	800	14	1080	28	90

## Movable Soft Pipe Installation (R)

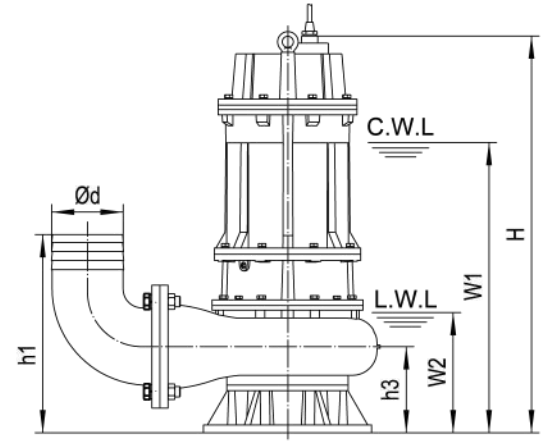
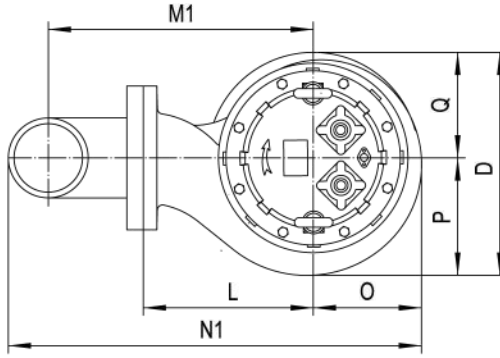

## Hard Pipe Installation(Y)

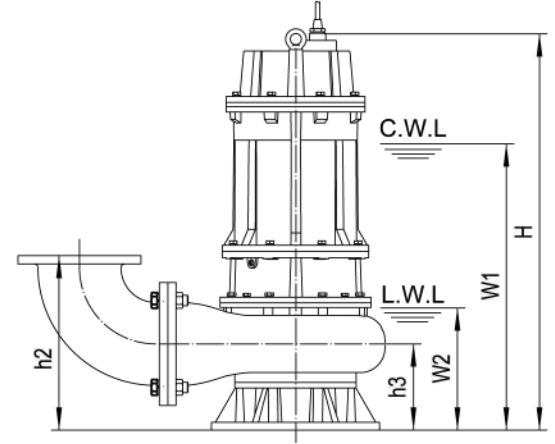
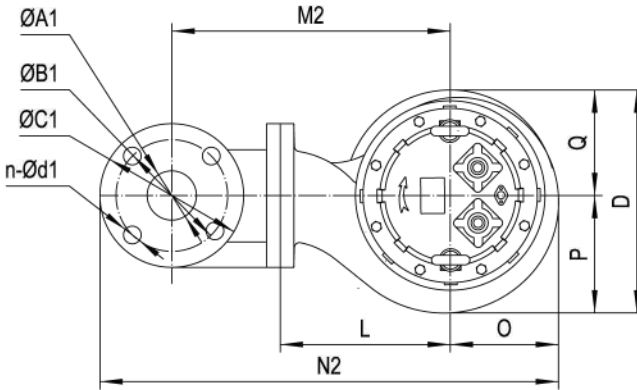

C.W.L : Continuous running water level  
L.W.L : Lowest running water level

## Dimensions table

Model	Ød	ØA1	ØB1	ØC1	n-Ød1	h1	h2	h3	W1	W2	H	O	P	Q	L	D	M1	M2	N1	N2
150B430	150	150	240	280	8-Ø22	475	450	250	855	340	1200	272	283	270	380	553	532	582	879	997
200B430	200	200	295	340	8-Ø22	580	500	270	895	380	1240	286	308	270	390	578	592	622	978	1078
250B430	—	250	350	395	12-Ø22	—	545	275	920	400	1265	300	332	270	410	602	—	683	—	1181
300B430	—	300	400	445	12-Ø22	—	630	310	970	450	1315	340	386	290	480	676	—	803	—	1365
150B437	150	150	240	280	8-Ø22	475	450	250	850	340	1255	272	283	270	380	553	532	582	879	997
200B437	200	200	295	340	8-Ø22	580	500	270	890	380	1295	286	308	270	390	578	592	622	978	1078
250B437	—	250	350	395	12-Ø22	—	545	275	910	400	1315	300	332	270	410	602	—	683	—	1181
300B437	—	300	400	445	12-Ø22	—	630	310	960	450	1365	340	386	290	480	676	—	803	—	1365
150B445	150	150	240	280	8-Ø22	475	450	250	890	340	1255	272	283	270	380	553	532	582	879	997
200B445	200	200	295	340	8-Ø22	580	500	270	930	380	1295	286	308	270	390	578	592	622	978	1078
250B445	—	250	350	395	12-Ø22	—	545	275	950	400	1315	300	332	270	410	602	—	683	—	1181
300B445	—	300	400	445	12-Ø22	—	630	310	1000	450	1365	340	386	290	480	676	—	803	—	1365

※Standard equipment of 250,300mm outlet dimension does not include the bend hose coupling

## Weights & Packing dimensions

Model	R			Y		
	N.W	G.W	Packing dimension	N.W	G.W	Packing dimension
	kg	kg	mm	kg	kg	mm
150B430	497	519	780×600×1440	505	527	780×600×1440
200B430	519	541	840×620×1480	527	549	840×620×1480
250B430	512	535	780×650×1500	559	582	780×650×1500
300B430	557	581	860×720×1550	602	626	860×720×1550
150B437	557	579	780×600×1490	565	587	780×600×1490
200B437	576	598	840×620×1530	584	606	840×620×1530

Model	R			Y		
	N.W	G.W	Packing dimension	N.W	G.W	Packing dimension
	kg	kg	mm	kg	kg	mm
250B437	570	593	780×650×1550	617	640	780×650×1550
300B437	614	638	860×720×1600	659	683	860×720×1600
150B445	593	615	780×600×1490	601	623	780×600×1490
200B445	612	634	840×620×1530	620	642	840×620×1530
250B445	606	629	780×650×1550	653	676	780×650×1550
300B445	650	674	860×720×1600	695	719	860×720×1600

## Auto-Coupled Installation (Z)

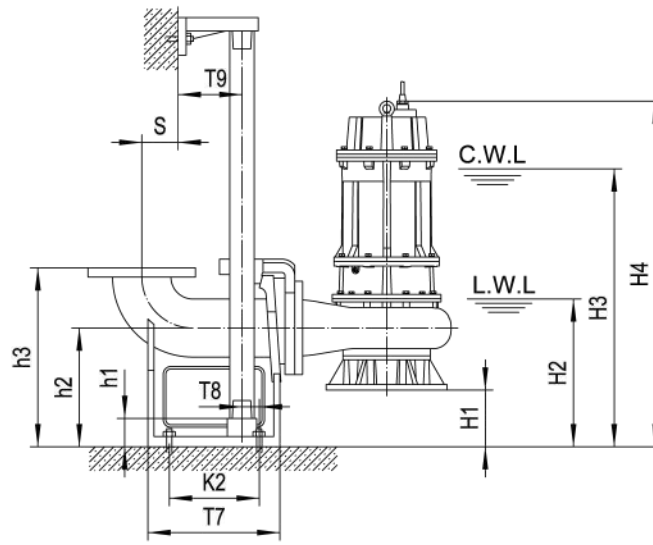
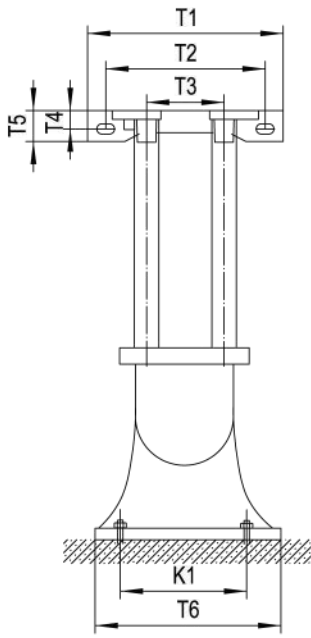

C.W.L : Continuous running water level  
 L.W.L : Lowest running water level

The coupling and pump will be packed individually, packing dimension and weight in table only refer to the pump, please refer to P58 to check coupling's packing dimension and weight.

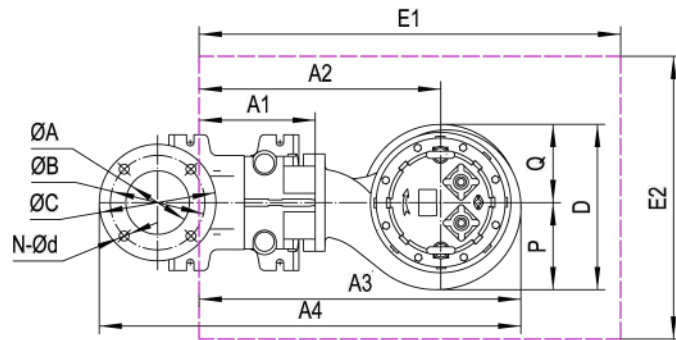

## Dimensions table

Auto coupling	ØA	ØB	ØC	N-Ød	T1	T2	T3	T4	T5	T6	T7	T8	T9	K1	K2	S	h1	h2	h3
150-150(PN10)	Ø150	240	280	8-Ø22	400	260	280	24	48	400	410	75	95	280	300	200	390	300	480
200-200(PN10)	Ø200	295	340	8-Ø22	400	260	280	24	48	400	445	100	95	300	355	230	440	325	555
250-250(PN10)	Ø250	350	395	12-Ø22	400	260	280	24	48	460	555	110	95	360	430	295	460	315	630
300-300(PN10)	Ø300	400	445	12-Ø22	500	320	360	32	65	550	570	95	115	414	410	270	570	400	730

## Dimensions table

Model	Auto coupling	H1	H2	H3	H4	A1	A2	A3	A4	P	Q	D	E1×E2	Pump weight & packing dimension		
														N.W	G.W	Packing dimension
150B430	150-150(PN10)	50	390	905	1250	285	665	935	1275	283	270	553	1150×700	485	507	780×600×1430
200B430	200-200(PN10)	55	435	950	1295	285	675	960	1360	308	270	578	1150×800	494	516	840×620×1470
250B430	250-250(PN10)	40	440	960	1305	310	720	1020	1510	332	270	602	1250×800	512	535	780×650×1490
300B430	300-300(PN10)	90	540	1060	1400	335	815	1155	1650	386	290	676	1400×800	557	581	860×720×1540
150B437	150-150(PN10)	50	390	900	1305	285	665	935	1275	283	270	553	1150×750	545	567	780×600×1480
200B437	200-200(PN10)	55	435	945	1350	285	675	960	1360	308	270	578	1150×800	551	573	840×620×1520
250B437	250-250(PN10)	40	440	950	1355	310	720	1020	1510	332	270	602	1250×800	570	593	780×650×1540
300B437	300-300(PN10)	90	540	1050	1450	335	815	1155	1650	386	290	676	1400×800	614	638	860×720×1590
150B445	150-150(PN10)	50	390	940	1305	285	665	935	1275	283	270	553	1150×750	581	603	780×600×1480
200B445	200-200(PN10)	55	435	985	1350	285	675	960	1360	308	270	578	1150×800	587	609	840×620×1520
250B445	250-250(PN10)	40	440	990	1355	310	720	1020	1510	332	270	602	1250×800	606	629	780×650×1540
300B445	300-300(PN10)	90	540	1090	1450	335	815	1155	1650	386	290	676	1400×800	650	674	860×720×1590

55~75kW 4P

50Hz : 1450rpm

60Hz : 1750rpm

45~55kW 6P

50Hz : 980rpm

60Hz : 1180rpm

## Specification

- Insulation class : F
- Protection class : IP68
- Starting method : reduced-voltage starting
- Water temperature : up to 40°C
- PH : 6 to 10
- Density of liquid : 1.3g/cm<sup>3</sup>
- Power supply : three phase 380V ±10%, 50Hz  
three phase 380V ±10%, 60Hz
- Capacity : up to 1900 m<sup>3</sup>/h
- Head : up to 61m
- Maximum immersion depth : 20m
- Cable Length : 10m



## Movable Soft Pipe Installation (R)

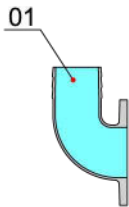

## Hard Pipe Installation(Y)

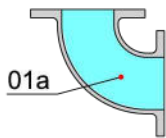

## Auto-coupled Installation (Z)

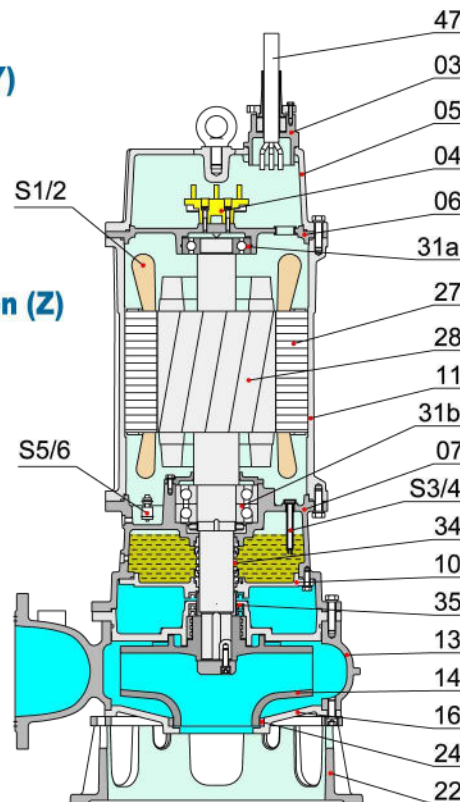
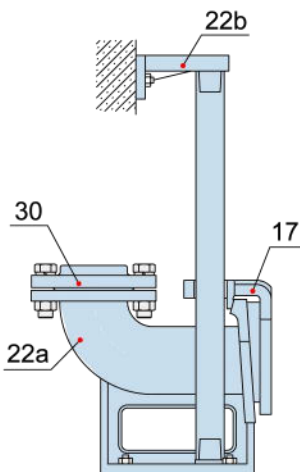

## Materials of construction

Item No.	Part name	Material
01	Hose coupling	Cast iron
01a	Hose coupling	Cast iron
03	Terminal box	Cast iron
04	Wiring terminal	
05	Upper cover	Cast iron
06	Up-Bearing house	Cast iron
07	Bearing house	Cast iron
10	Seal bracket	Cast iron
11	Motor body	Cast iron
13	Pump body	Cast iron
14	Impeller	Ductile iron
16	Inlet plate	Cast iron
17	Coupling adapter	Cast iron
22	Seat assembly	Cast iron
22a	Coupling seat	Cast iron
22b	Upper guide support	Cast iron
24	Neck ring	High chrome alloy
27	Stator	
28	Rotor	Shaft : AISI420SS
30	Flange	Cast iron
31a	Bearing	Ball bearing
31b	Bearing	Ball bearing
34	Mechanical seal	Sic-Sic
35	Oil seal	
47	Cable	
S1/2	Overheat protector	on option
S3/4	Oil water leakage probe	on option
S5/6	Floating switch	on option

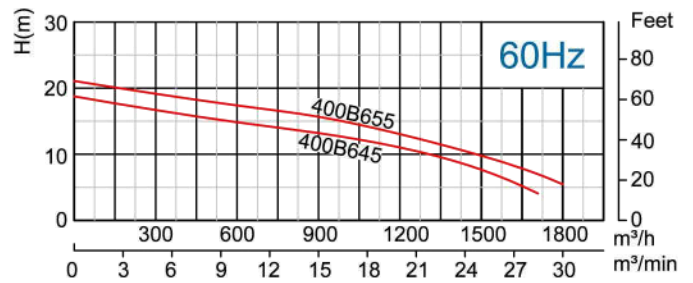
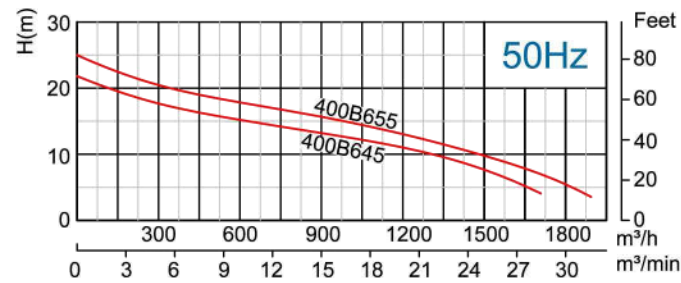
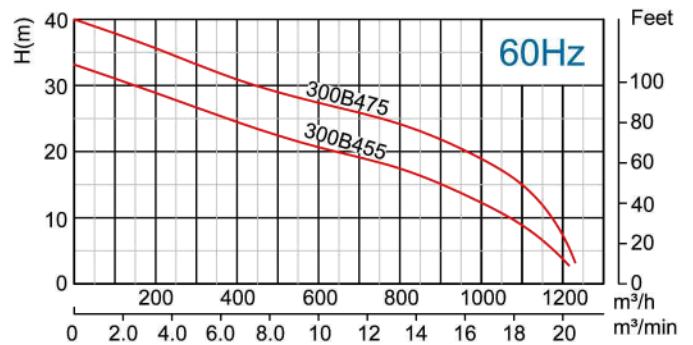
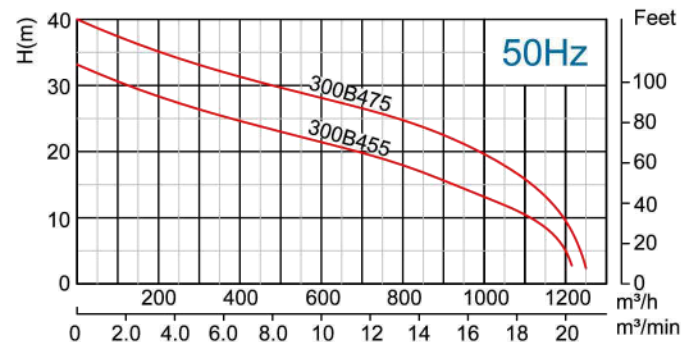
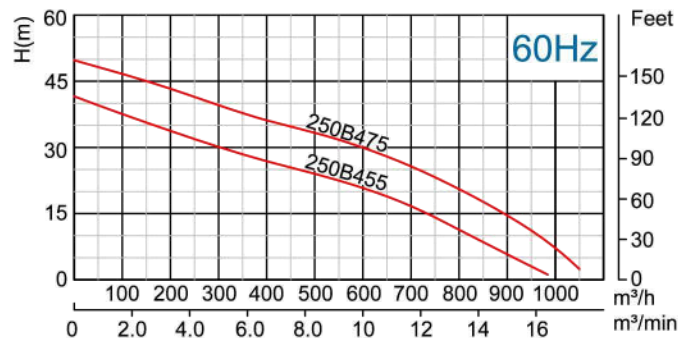
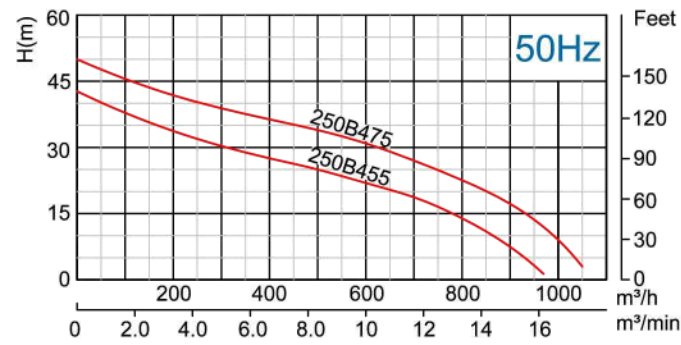
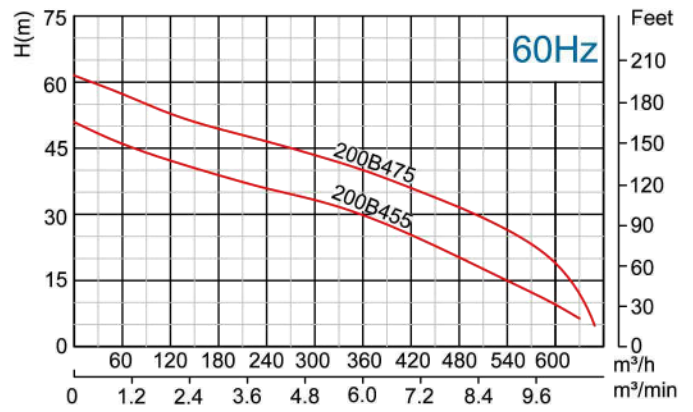
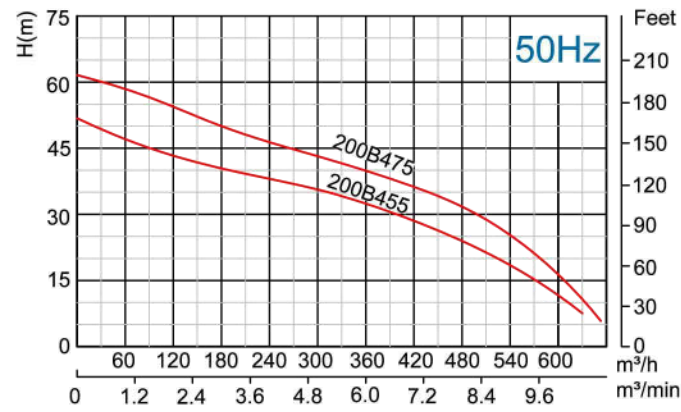

Model 50Hz/60Hz	Voltage	Current	Motor power		Outlet		Rated capacity	Rated head	Max capacity	Max Head	Impeller Passage
	V	A	kW	HP	in	mm	m³/h	m	m³/h	m	mm
200B455	380	105	55	75	8	200	300	36/33	630	51	80
250B455	380	105	55	75	10	250	500	25	970	42	90
300B455	380	105	55	75	12	300	800	18	1210	33	90
200B475	380	141	75	100	8	200	300	45/44	650	61	80
250B475	380	141	75	100	10	250	500	34	1050	50	90
300B475	380	141	75	100	12	300	800	25	1250	40	90
400B645	380	85	45	60	16	400	1200	11	1750/1700	22/18	120
400B655	380	105	55	75	16	400	1200	13	1900/1800	25/21	120

## Movable Soft Pipe Installation (R)

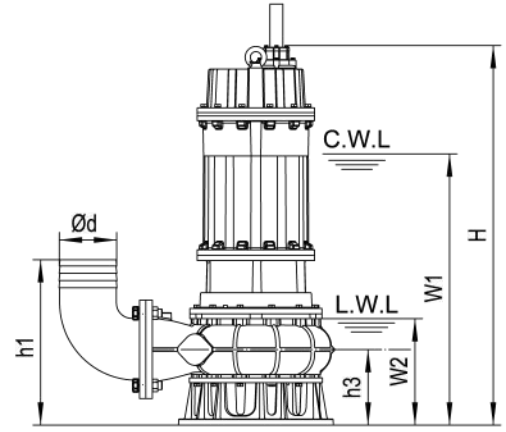
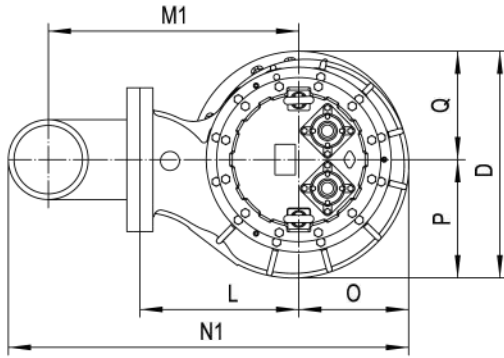

## Hard Pipe Installation(Y)

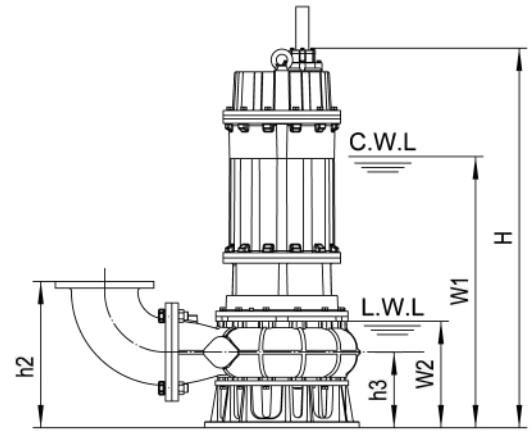
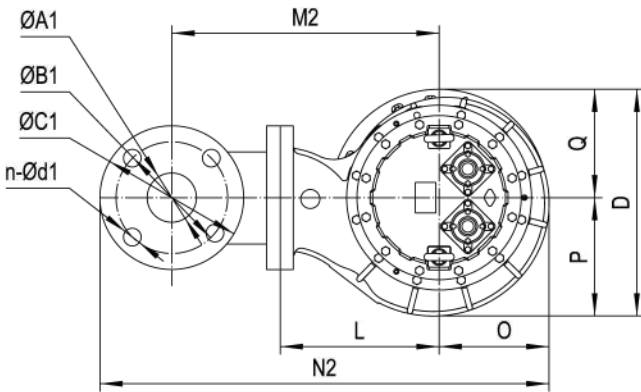

C.W.L : Continuous running water level  
L.W.L : Lowest running water level

## Dimensions table

Model	Ød	ØA1	ØB1	ØC1	n-Ød1	h1	h2	h3	W1	W2	H	O	P	Q	L	D	M1	M2	N1	N2
200B455	200	200	295	340	8-Ø22	604	524	294	1050	400	1540	320	323	320	440	643	643	673	1063	1163
250B455	250	250	350	395	12-Ø22	672	582	312	1080	440	1575	320	349	320	460	669	698	733	1143	1250
300B455	300	300	400	445	12-Ø22	/	649	329	1110	470	1610	359	398	320	490	718	/	813	/	1394
200B475	200	200	295	340	8-Ø22	604	524	294	1110	400	1540	320	323	320	440	643	643	673	1063	1163
250B475	250	250	350	395	12-Ø22	672	582	312	1140	440	1575	320	349	320	460	669	698	733	1143	125
300B475	300	300	400	445	12-Ø22	/	649	329	1170	470	1610	359	398	320	490	718	/	813	/	1394
400B645	400	400	515	565	16-Ø27	/	764	364	1190	540	1674	430	490	367	600	857	/	1004	/	1716
400B655	400	400	515	565	16-Ø27	/	764	364	1230	540	1674	430	490	367	600	857	/	1004	/	1716

※ Standard equipment of 250,300mm outlet dimension does not include the bend hose coupling

## Weights & Packing dimensions

Model	R			Y		
	N.W kg	G.W kg	Packing dimension mm	N.W kg	G.W kg	Packing dimension mm
200B455	809	841	940×720×1870	817	849	920×700×1890
250B455	802	834	860×740×1910	849	881	840×720×1930
300B455	829	864	920×790×1940	879	914	900×770×1960
200B475	884	916	940×720×1870	892	924	920×700×1890

Model	R			Y		
	N.W kg	G.W kg	Packing dimension mm	N.W kg	G.W kg	Packing dimension mm
250B475	872	904	860×740×1910	919	951	840×740×1900
300B475	903	938	920×790×1940	953	988	920×790×1930
400B645	930	975	1100×930×2010	975	1020	1100×930×2000
400B655	978	1023	1100×930×2010	1028	1073	1100×930×2000

## Auto-Coupled Installation (Z)

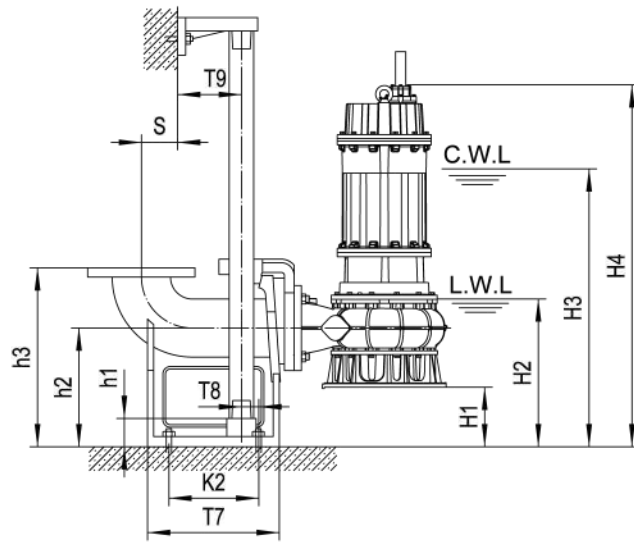
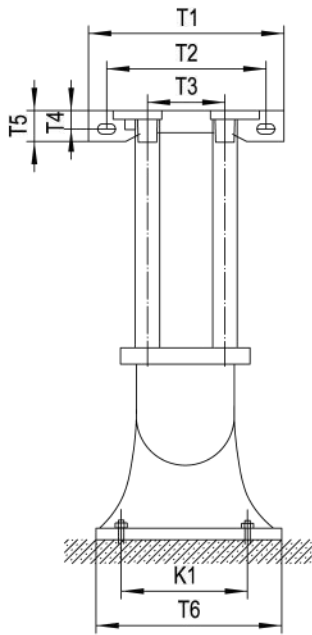

C.W.L : Continuous running water level  
L.W.L : Lowest running water level

The coupling and pump will be packed individually, packing dimension and weight in table only refer to the pump, please refer to P58 to check coupling's packing dimension and weight.

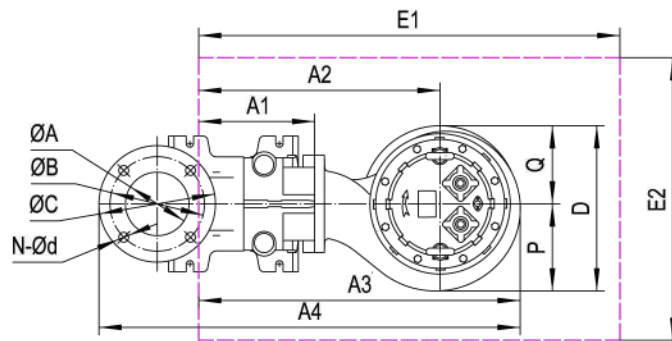

## Dimensions table

Auto coupling	ØA	ØB	ØC	N-Ød	T1	T2	T3	T4	T5	T6	T7	T8	T9	K1	K2	S	h1	h2	h3
200-200(PN10)	Ø200	295	340	8-Ø22	400	260	280	24	48	400	445	100	95	300	355	230	440	325	555
250-250(PN10)	Ø250	350	395	12-Ø22	400	260	280	24	48	460	555	110	95	360	430	295	460	315	630
300-300(PN10)	Ø300	400	445	12-Ø22	500	320	360	32	65	550	570	95	115	414	410	270	570	400	730
400-400(PN10)	Ø400	515	565	16-Ø27	520	340	375	32	65	620	660	100	115	495	525	365	770	480	960

## Dimensions table

Model	Auto coupling	H1	H2	H3	H4	A1	A2	A3	A4	P	Q	D	E1×E2	Pump weight & packing dimension		
														N.W	G.W	Packing dimension
200B455	200-200(PN10)	31	430	1080	1570	285	725	1045	1443	323	320	643	1300×800	787	820	920×700×1890
250B455	250-250(PN10)	3	440	1080	1580	309	769	1089	1582	349	320	669	1300×800	802	834	840×720×1930
300B455	300-300(PN10)	71	540	1180	1680	335	825	1184	1676	398	320	718	1400×900	829	864	900×770×1960
200B475	200-200(PN10)	31	430	1140	1570	285	725	1045	1443	323	320	643	1300×800	861	893	920×700×1890
250B475	250-250(PN10)	3	440	1140	1580	309	769	1089	1582	349	320	669	1300×800	872	904	920×700×1890
300B475	300-300(PN10)	71	540	1240	1680	335	825	1184	1676	398	320	718	1400×900	903	938	840×720×1930
400B645	400-400(PN10)	116	650	1310	1790	350	950	1380	2027	490	367	857	1600×1000	930	975	900×770×1960
400B655	400-400(PN10)	116	650	1350	1790	350	950	1380	2027	490	367	857	1600×1000	978	1023	920×700×1890